

R HODE
ISLAND
COLLEGE



SPRING 1986
COMMENCEMENT



Commencement Exercises

Saturday, the twenty-fourth of May
Nineteen hundred and eighty-six
Ten o'clock

PROCESSIONAL

Flourish for Wind Band . . . Ralph Vaughan Williams
Poetry and Power . . . Alfred Reed

OPENING OF THE CEREMONY

George M. Epple
Chair, Council of Rhode Island College

THE NATIONAL ANTHEM

Mary E. Phillips
Vocalist

INVOCATION

Robert A. Marcantonio
Chaplain, Rhode Island College

GREETINGS

His Excellency Edward D. DiPrete
*Governor of the State of Rhode Island and
Providence Plantations*
Albert E. Carlotti
Chairman, Board of Governors for Higher Education
Carol J. Guardo
President of the College

GOLDEN ANNIVERSARY GIFT

Helene Wynne Falvey
Mary V. McCaffrey
Class of 1936

SILVER ANNIVERSARY GIFT

Patricia A. Maciel
Class of 1961

CONFERRING OF HONORARY DEGREES

Candidates presented by
Willard F. Enteman
Provost and Vice President for Academic Affairs
assisted by
John Nazarian
Vice President for Administration and Finance

ADDRESS TO THE GRADUATES

James Schevill
Poet and Playwright

REMARKS

Douglas G. Cureton
M.A. Candidate

CONFERRING OF ADVANCED DEGREES

Candidates presented by
William A. Small
Associate Dean, School of Graduate Studies

FAREWELL REMARKS

Paul C. DePerry
President, Class of 1986



THE DEL SESTO MACE

At the 1959 Commencement Exercises, the first held on the present Mount Pleasant campus, Governor Christopher Del Sesto presented to Rhode Island College a bronze replica of the statue of the Independent Man so that the College, which up to that time had been located near the State House, might continue its tradition of holding commencements and other academic convocations in the presence of the Independent Man. The Del Sesto Mace, designed by the noted Rhode Island sculptor, the late Aristide Cianfarani, and crafted by the Gorham Company, has been in use since 1962 in all academic processions as symbolic of tradition and authority and, as well, of Rhode Island College's commitment to the search for truth, knowledge, beauty, values, and learning.

THE WILLARD MEDALLION

The Willard Medallion, symbol of the office of the presidency and worn at official and ceremonial occasions, links plates bearing the names of the chief executive officers who have led Rhode Island College since 1973. The sterling silver collar with enamel medallion was commissioned by the Rhode Island College Alumni Association and designed by silversmith Curtis K. LaFollette to commemorate the inauguration of Dr. Charles Borromeo Willard as the first alumnus to be named president of the College.

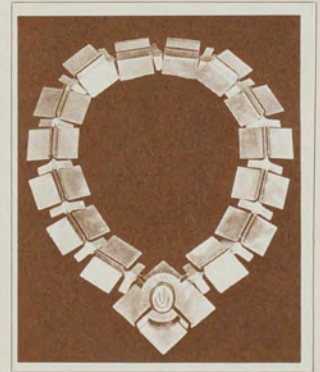

THE RHODE ISLAND COLLEGE SEAL

The official Rhode Island College seal, adopted in 1960, incorporates the anchor, symbol of hope and of the State of Rhode Island, with the founding date of the institution, 1854, and features the Flame of Life, adapted from the Holbrook Murals in the foyer of Roberts Hall. The flame is used in the murals to depict the energy that has supported over the aeons the development of all living things and has led man to his highest intellectual achievements. In like manner, the flame in the Rhode Island College seal stands for the life of the body and the life of the mind, symbolizing the human and intellectual goals and achievements of Rhode Island College.



HONORARY DEGREE RECIPIENTS

JAMES SCHEVILL

James Schevill, noted poet and playwright, taught at the California College of Arts and Crafts and San Francisco State University before his appointment to the faculty as professor of English at Brown University in 1968. Upon graduation from Harvard University in 1942 he joined the United States Army and served four years during World War II. His extraordinary talent was evident as early as 1945; while still in the Army, he wrote a play for radio, *The Sound of a Soldier*, which won a National Theater Competition. His works include 31 plays which have been performed in theatres from coast to coast and in Canada and England. Among them is a full-length musical, *High Sinners, Low Angels*, and the *Bloody Tenet*, a verse play about the trial of Roger Williams in 1636, which was commissioned by the National Council of Churches and the Central Congregational Church. It has played in San Francisco, Chicago, in England and Holland, and in a number of church and community theatres throughout the United States. Two of Schevill's full-length plays, *Lovecraft's Follies* and *Cathedral of Ice*, have been produced by the Trinity Square Repertory Company. James Schevill's most recent accomplishments are *Cult of Youth*, produced at the Playwrights Center in Minneapolis in 1984, and *Old Groucho's Game*, produced by the Rhode Island Playwrights Theater in Providence in 1985.

In addition, Mr. Schevill has published 27 works, both plays and poetry, the most recent of which were released in 1985 and include *The Invisible Volcano*, *A Long Poem*, *Oppenheimer's Chair*, *A Short Play*, and *Collected Short Plays*. He has also edited *Six Historians* by Ferdinand Schevill, coedited the *Wastepaper Theater Anthology* which includes four of his own short plays, and along with Margot Schevill, recorded *Performance Poems*. Since 1960 James Schevill has given numerous readings at colleges and universities throughout the United States and as far away as London and East Germany. At present, he serves on the board of the Trinity Square Repertory Company.

Winner of many awards and the recipient of highly prized fellowships and grants such as the Guggenheim Fellowship in Poetry in 1981 and the McKnight Fellowship in Playwriting in 1984, Mr. Schevill makes his home in Providence.



MARY ANN QUARANTA

Mary Ann Quaranta has served as dean of Fordham University's Graduate School of Social Service for over 10 years. During this time she has provided leadership for improving the quality of educational offerings, increased research and publication productivity by faculty, provided administrative direction for increased enrollment, promoted the development of a master's program at Tarrytown, established a doctoral program, initiated creative program development of special projects, and initiated and completed fundraising activities for the establishment of two endowed chairs.

Dr. Quaranta began her career as a psychiatric social worker following completion of a B.S. from the College of Mount Saint Vincent and an M.S.S.S. from Fordham University and opened a private practice with which she is still actively involved. Several years later, she was appointed to Fordham's faculty and rose through the ranks to full professor, a rank she holds today. While concurrently serving as director of field instruction and as coordinator of the Fordham University Graduate School of Social Service Extension Program, and prior to her appointment to the deanship, Dr. Quaranta earned a doctor of social work from Columbia University.

Mary Ann Quaranta, researcher, scholar, and published author, has an extraordinary record of community leadership. At the international level she serves as vice president for North America of the International Federation of Social Workers, and is on the Executive Committee and the Board of the federation; she is also a member of the United States Committee, International Council on Social Welfare. At the national level, Dr. Quaranta serves as president of the National Conference of Catholic Charities, is a member of the National Conference of Deans and Directors of Graduate Schools of Social Work, and is a chairperson on the Long Range Planning Committee of the Council on Accreditation of Services to Families and Children. At the regional level, she is on the Boards of Directors for Welfare Research, Inc. and the Astor Home for Children.

Dr. Quaranta received an honorary degree from Dominican College in 1980, the same year in which Fordham University bestowed upon her the Distinguished Alumna Award. She makes her home in Blauvelt, New York.



HENRY J. SHELTON

A native of Rhode Island, Henry J. Shelton has dedicated his life to helping his fellow citizens fight injustice in the social system. He studied at St. Raphael and Stonehill Colleges before completing his education at St. Mary's Seminary in Baltimore where he earned both a B.A. in 1953 and an STB in 1955. Returning to Rhode Island, he served the priesthood for nine years at St. Jude's Church in Lincoln before a transfer in 1966 to the directorship of the Catholic Inner City Apostolate in Providence provided him with the opportunity to learn the dynamics of organizing community organizations. In 1972 he left the priesthood to marry former nun Carol Reagan. They moved to Washington, D.C., where, at the National Urban and Ethnic Affairs Center, Mr. Shelton worked closely with the late George A. Wiley who was to become the inspiration for the development, years later, of the George A. Wiley Center. The center, founded in 1981 by Henry Shelton, who has served as its director since that time, is a resource center for community groups in Rhode Island. It provides a strategy for research assistance, fundraising support, and it promotes access to the media for new and established groups that comprise the elderly, the unemployed, citizens groups, and welfare rights groups. Wiley founded the Movement of Economic Justice, which serves as the model for the George A. Wiley Center today.

Mr. Shelton's far reaching accomplishments include founding the Catholic Inner city Apostolate, initiating the Rhode Island Fair Welfare Association, creating the Rhode Island Senior Citizens Action Committee, developing the Rhode Island Workers Association, providing the initiative for the formation of the Coalition of Consumer Justice and the Workers Association to Guarantee Employment, and successfully writing the grant proposals which funded these activities.

In addition to his efforts on behalf of Rhode Island's citizenry, Henry Shelton has taught classes and conducted workshops at the Community College of Rhode Island, the University of Rhode Island, Rhode Island College, and Bryant College. The Sheltons have five children, the youngest of whom is nearly two and the eldest twelve. They make their home in Cranston.



CONFERRING OF BACCALAUREATE DEGREES

Candidates presented by

David L. Greene

Dean, Faculty of Arts and Sciences

James D. Turley

Dean, School of Education and Human Development

George D. Metrey

Dean, School of Social Work

CLOSING OF THE CEREMONY

George M. Epple

ALMA MATER

RECESSIONAL

March from "Second Suite in F" . . . Gustav Holst

HONORARY DEGREES

DOCTOR OF PEDAGOGY

Mary Ann Quaranta

Social Work Educator and Professional Leader

DOCTOR OF PUBLIC SERVICE

Henry J. Shelton

Humanitarian and Social Activist

DOCTOR OF HUMANE LETTERS

James Schevill

HONOR CORDS

Undergraduates who are receiving their degrees today with honors have the privilege of wearing special "honor cords." The color of the cord indicates the level of the honor as follows:

Summa cum laude . . . gold

Magna cum laude . . . blue

Cum laude . . . white

*Gail S. Lury-Gunther
Mary Mustafa
Diane P. Newman
*Valerie Olesky
*Stewart M. Shaffer

**SPECIAL EDUCATION—
ELEMENTARY
SPECIAL NEEDS,
LEARNING DISABILITIES**

Carolyn M. Baluch
Joyce C. Carter
Patricia C. Corso
Aurelia A. DeAngelis
*Doris E. LaPorte
Arlene M. Rankowitz

**SPECIAL EDUCATION—
MODERATELY / SEVERELY /
PROFOUNDLY
HANDICAPPED**

*Maryann Barresi
Diane E. Hyland
Cheryl A. Silva

**SPECIAL EDUCATION—
PRESCHOOL
HANDICAPPED**

Mary A. Bresadola
*Nancy Poon

**SPECIAL EDUCATION—
SECONDARY
SPECIAL NEEDS**

Frances Anderson
Patricia S. Carney
Susan Dumouchel
Jo-Ann M. Masterson
Andrea L. McCormick
Roberta J. McLearn
Judy Ruck

Master of Science

**INSTRUCTIONAL
TECHNOLOGY**

Charles Allsworth
Diane R. Azevedo Carns
John R. Conte
David A. Wilson

Master of Social Work

Donna L. Ardito
Lisa B. Bahner
Jeanne Bazalak

Waltraut M. Benjamin
Sharon L. Blivas-Taylor
Linda A. Boutilier
Monica C. DeCubellis Chace
Mark L. Colton
Francine M. Connolly
Virginia A. Wroblecki Creamer
Richard H. Doolittle
Brenda J. Dziedzic
Christine Dooley Ellis
Carol J. Farb Fishbein

Juanita Handy Scholar

Susan C. Franchetti
Elizabeth L. Gerhardt
Francis J. Giambrone
Barbara A. Gianola
Lisa E. Giusti
Helen E. Halpin
Pamela L. Kaitin-Miller
Marie F. Kelley
Theresa M. Landry
Christine A. Marshall
Marilyn A. Matzko
Helen M. McCarthy-Deines
Jeffrey D. Noll

Dennis J. Orsi
Mary G. Davey Scholar

Thomas J. Patota
Denise B. Poirier
Cheryl A. Procaccini
James A. Ryan
Laura N. Ryan
Carol J. Schigg
Cleo J. Senor
Joan Sheff
Kathleen M. Siekierski
Alfred J. Silva
Rochelle L. Sokoll
Maryellen Sullivan
Debra L. Thorne
Kathie A. Toner-Walkden
Elaine M. Verity
Mary F. Waldron-Mello
John M. Whalen
Robert G. Whitman-Raymond

SCHOOL OF GRADUATE STUDIES

Certificate of Advanced
Graduate Study

COUNSELOR EDUCATION

*William E. Densmore III
Arthur J. Sepe, Jr.

**EDUCATIONAL
ADMINISTRATION**

*Frank J. Gamble III
*Michael J. Vieira

**INSTRUCTIONAL
TECHNOLOGY**

Arthur J. Mendonca

READING

Marlyce L. Adams

SCHOOL PSYCHOLOGY

Martha Callan
Theresa M. Connor
Patti A. Ferguson
Paula J. Rinebolt
*Joann Sizemore

Master of Arts

AGENCY COUNSELING

*Margery A. Boyer
Ann S. Buchanan
*Ernest J. Campagnone, Jr.
Jose Q. Dos Reis
Diane C. Dufresne
*Catherine A. Giard
Linda P. Hunt
Teresa M. Kless
*Jayne O'Neil
*Suzanne B. Petersen

BIOLOGY

Sandra J. Gannon

**DEVELOPMENTAL
PSYCHOLOGY**

Marie V. Citrone
Patricia Mathieu

**EDUCATIONAL
PSYCHOLOGY**

Susan P. Casey
*Corrina A. Daley
Elaine M. Nardolillo

FRENCH

Patricia G. Penza

**INDIVIDUALIZED
PROGRAM**

Michael L. Angell, Sr.
†Douglas G. Cureton
Marion McLaughlin
Olon Reeder

MATHEMATICS

Robert H. Dubuc, Jr.
Thomas J. Pandolfini

**PERSONALITY AND
SOCIAL PSYCHOLOGY**

Elizabeth A. Aloisio
Ralph A. Detri
James M. Henry
Elinor J. MacDonald
Joyce LaFazia Mollicone
Ralph Orleck
Edward L. Pacheco
Marcia M. Pollo

**REHABILITATION
COUNSELING**

*William T. Bull
Patricia A. Peach Droth
Agnes M. Johnson
Judith B. Lavine
*Colleen A. Redding
Paula J. Torvi
Charlotte J. Wal

Master of Arts
in Teaching

ART EDUCATION

Carol H. Bliss
Elaine M. R. Gauthier
Patricia A. Lucciola
*Laurie A. Scialabba

BIOLOGY

*Elaine Anderson
Suzanne L. Dailey
David L. McLaughlin
*Dorothy J. Zaida

ELEMENTARY EDUCATION

Jeannette K. Calhoun
Kathleen M. Magan-Smith

ENGLISH

*Patricia L. Kehoe
*James A. Matuszek
*Linda A. Nagle
Robert J. Pilkington
Anne Marie Quattrucci
Sandra A. Storti

HISTORY

Wanda L. Gilbert
Kenneth C. Perry
*John E. Peterson, Jr.

**INDIVIDUALIZED
PROGRAM**

Daniel R. Mello
Denice E. Mitchell

MUSIC

Rena Z. Akalarian
*Edward J. DeFusco
*Paulette M. LaParle

PHYSICAL SCIENCE

*John W. Hurley, Jr.

SPANISH

Miguel A. Gomes

Master of Education

**BILINGUAL-BICULTURAL
EDUCATION**

Lila M. Gray

**EDUCATIONAL
ADMINISTRATION—
ELEMENTARY**

Madeline R. Nasiff
*Stephen C. Ponte
Judith A. Richardson
Nancy L. Travis

**EDUCATIONAL
ADMINISTRATION—
SECONDARY**

Virginia L. Currie
Lucille Girard
Paul C. Stroup

ELEMENTARY EDUCATION

*Suzanne M. Chapman
Jeannine A. D'Agostino
Donna A. DeCurtis
Lori A. Romano Fogarty

Annette E. Granata
Linda Robertson
Lori J. Williamson

**ELEMENTARY EDUCATION
—EARLY CHILDHOOD**

*Claire M. DaSilva
Elaine V. Maggiacomo
Hilda M. Potrzeba

**ENGLISH AS A
SECOND LANGUAGE**

Jane H. Byrne
Janice M. Scaglione Hammoud
*Lillian M. Hayman
Mei Mei Hu
*Norman Jefferies
*Helen L. Kagan
Marileia Lucciola
*Francine A. Montella
*Anne Marie Quattrucci

HEALTH EDUCATION

Meredith F. Brouillette
Norma A. Faraone
Ann E. Laffey
Caroline E. McGuirl
Lorraine M. Nault
Marylou Sicco

**INDIVIDUALIZED
PROGRAM**

Ronald G. Beckett
Elizabeth A. Dalton
Sabina M. Rei

INDUSTRIAL EDUCATION

Joseph A. Bagaglia, Jr.
Ronald Black
David A. Geraghty
Robert C. White

READING

Monica M. Cook
Paula T. Richards
*Linda Robbins
Carol M. Weiner

**SPECIAL EDUCATION—
ELEMENTARY
SPECIAL NEEDS,
BEHAVIOR DISORDERS**

Irene S. Cappalli-Marion
*Nancy L. DiLorenzo

*AUGUST 1986 GRADUATE

†JANUARY 1986 GRADUATE

- Anthony A. Kaczmarek
cum laude
- Charles Kando
- Lisa M. Kastens
- Karen A. Kelly
- Jacqueline E. Kiernan
- *Deborah Kilsley
- Kathryn M. King
- Kristen P. King
Gold Key Society
- *William H. Kirk
- Christine A. Kureck
- Lynne M. La Bianca
- Anne M. Labonte
cum laude
- Michael L. Laferriere
- Susan L. Landry
cum laude
General Education Honors
Helen M. Murphy Award
- *Sheila A. Lapierre
- Mary E. Lapointe
- Edward Laprey
- Scott R. La Salle
cum laude
- *Inga J. Laurila
- Teresa A. Lawrence
General Education Honors
- Gail H. LeBlanc
- Lisa A. Lepizzera
cum laude
- Karen J. Lepore
- Rosa K. Leung
- Melissa A. Leverett
- Bethany A. Lewis
- *Lynda A. Lewis
- Yanina Leyfman
cum laude
Honors in Management
- Barry M. Licker
cum laude
- Mary P. Liebermann
- Elizabeth E. Lobato
cum laude
Bertha Christina Andrews
Emin Award -
Scholastic Excellence
- Maria L. Lopes
- *Maria E. Loskoutov
- John P. Luciani
- Darlene A. Lussier
magna cum laude
- Paula Lynch
- *Paula Susan Lynch
- Bruce MacDonald
cum laude
- Mary-Ellen Macksoud
Lauris B. Whitman Award
in Sociology
- Gregory S. Mailloux
- Carolyn A. Mannis
cum laude
- *Lori J. Margadonna
- David P. Marion
- Denise M. Marro
- Anne Marie Marsland
- Gina-Marie Martin
cum laude
- Michelle M. Martineau
cum laude
- Diane M. Martinelli
- Glenn A. McCartney
- Nadine P. McDonald
- Kathleen M. McGill
summa cum laude
- Jane P. McGinn
- *Karen A. McGovern
- *Kevin C. McGrath
- Terriane McGrath
- Shirley A. McGunagle
- Lise Y. McKay
- Laurie A. McKenna
- *Matthew A. McKenna
- Mary C. McLaughlin
- Patricia A. Melaragno
- *Robert P. Menard
- *Betty M. Mencucci
- Joseph A. Merolla
- *Beatrice Y. Metts
- Valerie E. Michael
cum laude
- Pamela L. Milligan
magna cum laude
General Education Honors
Honors in Economics
Honors in History
Bertha Christina Andrews
Emin Award -
Outstanding Achievement
Wall Street Journal Award
- *Robert Minicucci
- Joseph A. Minor
cum laude
- Marina G. Mitchell
- Thomas W. Molloy
- James P. Monahan
- Denise M. Mowchan
magna cum laude
Honors in Anthropology
James Houston Award in
Anthropology/Geography
- Gaetano M. Murgio
- *Marianne Murphy
- Roberta Nascimento
- *Robert P. Nasiatka
- Elizabeth B. Newberry
- Mark J. Newhouse
- Diane M. Niederberger
- Richard N. Noel
Richard A. Howland
Computer Science Award
- Craig S. Noke
- *Mark S. Norton
- Jacqueline Nutini
- Donald J. O'Donnell, Jr.
magna cum laude
- Thomas J. O'Gorman
- *Stephen O. Ogundipe
- Janet R. Oulousian
- Ahmet Ozdemir
- David J. Pagliaro
- Leslie R. Papp II
cum laude
Richard A. Howland
Computer Science Award
- *Marc R. Pappas
- *Ronald G. Parent
- Elizabeth A. Paroli
- Shawn Parsons
- Kimberly A. Pastore
- *Michael L. Pastore
- Sandra L. Patrick
cum laude
- *Moises Peguero
- Neil C. Peirson
- Denise P. Peloquin
magna cum laude
- Richard A. Pereira
- Janet L. Peterson
- Linda L. Phelps
- Mary E. Phillips
cum laude
Rhode Island College
Theatre Award
- Donna M. Pillsbury
- Marcelino F. Pimentel
- Blair L. Pointe
- Dorothy A. Poirier
- Ronald G. Poirier
- Clifford A. Ponte
- *Neil J. Pothier
- *Alison J. Prior
- Kathryn Provonsil
- Melissa E. Raimbeault
- Robin A. Rainone
- *James S. Ramsey
- *Lucinda A. Ramsey
- John A. Reeder
- Francis Joseph Rego
- Barbara M. Reo
Rhode Island College
Theatre Award
- *Bienvenida A. Reyes
- Guen Reyes
- Elaine M. Ricci
- Maribeth Rice
cum laude
- Paul F. Riley
- Maryann E. Robinson
- Maria A. Rodrigues
- *Lynn A. Rosario
- Daniel T. Ross
- Michael Ross
- Laurie J. Rothemich
- Annmarie Rotondo
summa cum laude
- Diane M. Russell
cum laude
- *Desiree M. Santilli
- Sallyann Savoie
- Christopher J. Scanlan
- Margaret M. Schlageter
- Mary A. Seebeck
- Malcolm Serabian
- Cheryl A. Serras
- Patrick J. Sherlock
- Lisa A. Silva
- Catherine J. Simon
cum laude
General Education Honors
- Janet S. Smiley
- Ann S. Smith
- Margaret R. Snowden
cum laude
- Kristina Soderlund
- Donna M. Souza
cum laude
- Peter J. Spadetti
- Mark J. Spalding
- Christine A. Spillane
- *Phyllis A. Spring
- Dawn M. Stickney
- Emberley A. Strong
cum laude
- Francis J. Strocio
- *Fluvia A. Suazo
- *Angela J. Sullivan
- *Christopher Alan Sullivan
- Sheila A. Sullivan
- David G. Swift
- Laurie A. Sylvia
- Robert M. Tallman, Jr.
- Sara C. Tapia
- Linda A. Tarantelli
- Diane Tarricone
- Ann Marie Tasca
- Sharon A. Tatalo
magna cum laude
- John P. Tavanian
magna cum laude
- Patricia A. Tavares
- Scott R. Tellier
- *Audrey M. Tessier
- Patricia L. Testa
cum laude
General Education Honors
- *Christine Testoni
- Michele Thivierge
- Beth A. Thomas
cum laude
Jean Garrigue Award

FACULTY OF ARTS AND SCIENCES

Bachelor of Arts

LIBERAL ARTS

Barbara A. Aballo
cum laude

Joseph A. Abruzzese

*Heidi B. Ackaway

Eliseu Afonso

Marcie B. Akell

*Abiola M. Akinbola

Tina M. Alessandro

*Tracy E. Allen

Michele F. Alleva

Lisa M. Ambrifi

Evangeline M. Anderson
*Peter Jeffrey Archambault
Memorial Award*

Mary T. Andrade

Deborah A. Andrews

Linda J. Arage
cum laude
*Yetta Rauch Melcer
Dance Award*

Gloria A. Aranki

Debra J. Archambault

Patricia A. Arego

Andre R. Audette
magna cum laude

Raymond W. Auger

Kristel B. Bagjan
magna cum laude
General Education Honors

Kara E. Baglini

*Karina E. Baker

Lloyd D. Baker

Ana M. Baltazar
*Nelson A. Guertin Memorial
Award - Spanish*

Agnes C. Barboza
cum laude

Nancy L. Baril

Susan C. Bartone

Judith Bazinet

Daniel L. Belhumeur

Claire C. Belisle

Marilyn I. Bellemore

Eileen J. Benz

Sara L. Benz

Robert S. Bernstein
magna cum laude
Philosophy Faculty Award

*Jeanne H. Berthasavage

Paul Berthelette

Marianne Biello

Linelle M. Blais
magna cum laude
Psychology Faculty Senior Award

Licia C. Boghossian

Donald Bolen

Roy M. Borges

*Kara M. Bowen

Andrea L. Braica

Joanne Breault

Catherine M. Briganti
cum laude

*Timothy J. Brooks

Robyn C. Brown

Carla A. Buckham
cum laude

Patrick T. Burke

Michael J. Butler

Kenneth M. Cadow
cum laude

Walter F. Caffey

Thomas A. Cahir III

Sarah A. Caizzi

Gregory J. Caldarone

Karen L. Calderone
cum laude

Steven P. Calenda

Pamela E. Callanan
cum laude

Daniel E. Campbell

Robert A. Carcieri

Steven H. Caron

Maura J. Carroll
magna cum laude

*Frank L. Celseti

Anne M. Chapman

John J. Charette
cum laude
General Education Honors

David J. Chianese

Emily F. Choquette

Maureen Church

Peter J. Clements

Roy F. Clements

Susana M. Coelho

Stuart A. Cohen

Andrea Concepcion

Sandra C. Conley

David S. Cooper
Gold Key Society

Brian D. Correia

Michael J. Crocker

Normand L. Croteau

Anthony J. Crudale

Carol A. Cullen

Paul Cully

Lois M. D'Ambr

*Kenneth P. DaSilva

Manuel F. DaSilva

Sueann N. Daugherty
cum laude

Patricia M. Davey

Donna L. DeBiasio
cum laude

*Michael R. De Felice

*Loretta M. Deffert

Kenneth W. deHertogh

Mitchell S. Delaney

Anthony J. Del Santo

Sara F. DeMeo

David R. Denman

Paul C. DePerry

Francis T. Devine

Adelino S. Dias

Alan S. Dias

*Elsa Dias

Julie A. Dias
cum laude

Robert A. DiStaolo

*Michelle A. Dogon

Jerzy R. Dominczak

Gary D. D'Orsi

Kenneth B. Dorval
cum laude
John E. Hetherman Award

*Lisa M. Doucet

Donna M. Duarte
cum laude

Susan Dube
cum laude

Lois C. Duckworth

Lisa A. Duquette
magna cum laude
General Education Honors

David R. Dusseault

Janet R. Dutilly

*Marcia J. Eagleson

*Joanne A. Eichholz

Maria C. Elgar
magna cum laude
Honors in Biology
W. Christina Carlson Award

Maria E. Falco

Andrea D. Falso
cum laude

Robert S. Farrell

Kara M. Fay
cum laude

Jonathan D. Fayne

William J. Fazioli
cum laude

Ann M. Fegatelli

Lu-Ann Ferrucci

*Liliana Fijman
cum laude

*Susan Elaine Fleet

Jonathan A. Flint
cum laude

Joseph W. Fogarty III

Robert D. Foley III

Karen M. Fontaine

Joseph D. Francis

Francisco J. Furtado

Deneen A. Fusco
cum laude

Albert G. Gaboriault

Gayle A. Gallagher

Mary K. Gallagher

Kathleen M. Gardner

Mary-Beth Gauthier

*Lucille Gay

Peter T. Graynor

Joann T. Gerard
magna cum laude

John Gilheeny
summa cum laude

John P. Gill

Kyle F. Gillett

Brian R. Glantz

Debra J. Godin
magna cum laude
General Education Honors

Carol A. Grady

Norman L. Grant

Mary E. Green

Donna M. Gregoire

Laurie A. Grieco
John H. Chafee Award

*Philip T. Griffin

David L. Griffith

Paul E. Grimaldi

*Janice J. Grondalski

Lisa K. Gudaitis

Cheryl D. Guglielmo

*Elizabeth A. Haffner

*Matthew J. Hamel

Anne M. Hanley

Sharon P. Hansen

Bernardine A. Harper

Kerstin G. Harper
summa cum laude

Gregory P. Hazian

*Daniel F. Healy

Norman Hebert

Mark C. Hitchcock

*Holly W. Hogarth

*Linda L. Hornsby

Dorothy Howarth
magna cum laude

Susan E. Howe

Stephen J. Ianiere

John J. Iglizzo

Patricia M. Inman
cum laude

Denise M. Jackson
cum laude

Deborah A. Jamieson

Joseph Jancef

Stacey A. Jenson

*Christine E. Johnson

*Jane E. Johnson

Shantannett P. Jones

*Carolyn A. Jordan

Jane M. Joseph
cum laude
Gold Key Society
*American Institute of
Chemists Award*

*Philip E. Gregoire
Joseph J. Guadagni
Sean Healy
*Jean E. Herard
*Kristen A. Phillips

MEDICAL TECHNOLOGY

Michelle A. Couturier
Rebecca E. Dauplaise
Craig A. Duffin
magna cum laude
Theodore Lemeshka Award
Sandra K. Herning
Maria L. Lopes
Charlene A. Lussier
magna cum laude
Dolores M. MacKenzie
cum laude
Amanda J. Maynard
Walter M. Mournighan
Donna M. Smith
Deborah A. Voas

NURSING

Stacey Aguiar
Karen P. Albert
David C. Anderson
Anne W. Arieta
Nursing Faculty Award - R.N.
Maryann D. Arruda
Vera M. Assante
cum laude
Leah M. Balassone
cum laude
General Education Honors
Patricia S. Baumgartel
Cynthia E. Berry
Donna M. Blackledge
Darlene C. Bodami
cum laude
Lynn A. Breault
Joan E. Brennan
Dorothy M. Brockington
Laurie J. Brown
Karen L. Calderone
cum laude
*Tammi M. Cardillo
Ann M. Cervini
Eileen M. Chagnon
Daria Chang

Maria Collelo
Patricia A. Couturier
Lorinda S. Crowley
Diane L. Dearing
Lisa M. DeFrancesco
Robert L. DeKeulenaere
summa cum laude
Lynn M. Denning
cum laude
Michele DePalo
Steven E. DiChiara
Christine C. Durand
Margaret E. Dwyer
Elizabeth B. Farris
Elizabeth M. Farrell
Lynn M. Fernandes
Louise A. Figliola
Lori E. Fisher
Donna L. Flanagan
Rachel G. Fontaine
Marsha D. Foster
Mary-Ann Fraccola
cum laude
Caroline D. Gaines
Patti A. Gamboa
cum laude
Susan M. Gentile
Susan A. Georgantis
cum laude
Marilyn A. Giardino
Patricia E. Gill
Cheryl A. Gleason
Gold Key Society
Michelle S. Gosselin
Nancy A. Gouveia
Carla R. Graziani
cum laude
Arlene E. Greene
Michelle A. Guillette
Yvonne F. Gunning
Anne M. Hanley
Julie A. Hanlon
Marissa W. Healy
Nancy A. Hilton
Linda M. Hindle
cum laude
Gail A. Holm
Eileen F. Hurewitz
Joseph C. Jackson
cum laude

Jane A. Jagielo
Rachel R. Johnson
Lori M. Kelley
Elizabeth V. Lachance
cum laude
Lisa M. Lagasse
Nursing Faculty Award - Generic
Normand J. Laliberte, Jr.
Elizabeth A. Lambert
Mary D. Lambert
Jean E. Lanctot
cum laude
Pauline L. Langlois
cum laude
Kathleen M. Lappin
Michele A. Lemieux
Cheryl L. Lewis
Lynda A. Lewis
magna cum laude
Claire L. Licciardi
cum laude
Marilyn J. MacDonald
cum laude
Theresa Magellan
Margaret M. Mahony
Susan M. Maiato
Jean M. Marandola
Marilyn S. Marcotte
Angela M. Marshall
Gina-Marie Martin
cum laude
Kimberly P. Martone
Joanne A. McCarthy
Nadine P. McDonald
Carolyn A. McGillivray
Laurie A. McKenna
Diana Menard
Lucia A. Micheletti
Joann F. Mitchell
Lynn M. Mollohan
Maureen A. Montalbano
cum laude
Colleen A. Motta
Joyce A. Mucci
Elizabeth H. Neubauer
June A. Newman
Lisa M. Nolan
Cynthia M. Norman
Lisa M. Palagi
Sandra A. Papitto

Linda M. Pare
Therese B. Pare
John P. Partridge
Mary-Ann D. Pasterczyk
Elizabeth A. Patnaude
Julianne M. Piquette
cum laude
Lori A. Potenza
Carolyn M. Pucci
Suzanne P. Ream
Joanne M. Reis
cum laude
Roberta M. Riccio
magna cum laude
Maria C. Romano
June Kuznar Roy
Brenda Rustigian
Brenda G. Ryan
Colleen H. Ryan
Lucille M. Sauve
magna cum laude
Lucy A. Scanlon
*Jacquelyn Schaeffer
Mary A. Seebeck
Sandra S. Shaw
Allison T. Sheedy
Deborah L. Silvia
Theresa A. Silvia
Janet S. Smiley
Cheryl A. Souza
Brenda L. Stapan
Donna M. Sullivan
Laurie A. Sylvia
Geraldine A. Tamborelli
*Aline A. Tetreault
Tracey T. Theodore
Kathleen Tudino
cum laude
Lauren M. Tullie
Sherry M. Ustas
Susan M. Venter
Gold Key Society
Richard E. Webster
Karen L. White
Kim A. Williams
Martha E. Willis

Robert J. Tidwell
cum laude
Donald E. Tirrell
Diane L. Tomassi
Christopher A. Toti
*Robin K. Turner
*Sally V. Turner
cum laude
Edward Valerio, Jr.
*Nancy D. Van Hoose
*Nicole M. Vanasse
Michael S. Vaphiades
cum laude
Jeanne L. Vetter
cum laude
Thomas W. Viall
magna cum laude
*Albert J. Vitali, Jr.
*Joan R. Vredenburgh
Patricia A. Waddington
magna cum laude
*Lucinda Wadsworth
*Leanne E. Walker
Veronica M. Walsh
Meridith H. Ward
Evelyn Walsh Prize
Deborah J. Watts
summa cum laude
*Mary M. Wayland
Mary Ellen Wessler
cum laude
*Lorraine D. Wilby
Billy G. Willett
Dwight Williams
Osborne D. Williams
Theodore Lemeshka Award
Timothy A. Williamson
Kenneth S. Winslet
Kenneth A. Woodbine
magna cum laude
Thomas A. Worthington
*Kathleen M. Zeller

Bachelor of Fine Arts

STUDIO ART

Patricia A. Cronin
cum laude
Studio Art Award
Paul F. Forsythe
cum laude
Linda M. Rupert

Bachelor of General Studies

Robert Chevalier
*Deborah A. Collins
Michelle Cormier

*Jerry H. Elmer
Mary R. Iarussi
*Patricia M. Izzi
cum laude
*Rhejeanne D. Marechal
Josephine O'Connell
June M. Place
cum laude
Donna M. Rainone
Margaret A. Rose
Sandra H. Smith
magna cum laude
Joan E. Teadt
Gloria H. Wallace
Henry Francis Winthrop

Bachelor of Music

MUSIC PERFORMANCE

Patrice R. DeIPonte
Mary E. Phillips
cum laude
Rhode Island College
Theatre Award
*Shirley E. Quetta
*Paul J. Thomas
cum laude

Bachelor of Science

ACCOUNTING

Paul A. Demers
Leo P. DeRoy
Steven M. Ellard
*Doris L. Englert
Nicole R. Forcier
Michele L. Kramer
Daniel C. Murphy
Robert T. Nelen
Marylu Notarianni
*Glenna P. Payne
Jane R. Peach
magna cum laude
Marie E. Pozzi
magna cum laude
John Silva Memorial
Scholastic Award

COMPUTER INFORMATION SYSTEMS

David W. Butler
*Ernest W. DiSpirito
Donna M. Laliberte
Michael R. Lyons
Roger M. Messier
Daniel Ramos
cum laude
Lansen R. Ramsbey
*Michael W. Sanda

LIBERAL ARTS

Mark S. Bartley
Gloria D. Black
*Kevin D. Costa
*Gloria Y. Henriquez
Denise M. Jackson
cum laude
*Fidan Kucukkaya
Gail A. Murphy
Jill P. O'Brien
summa cum laude
Ronald J. Boruch Award
Charles J. Shadoian, Jr.
Robert J. Tomasso
Michael S. Vaphiades
cum laude

MANAGEMENT

John E. Almeida
Marc C. Anderson
Andrew J. Arruda
*Robin L. Bessette
Carol L. Best
*Russell Blackledge
Mary J. Bonafede
magna cum laude
George H. Bowen
William J. Callahan
*Gino Caputo
Peter J. Casale
Robert J. Clarkin
Kevin J. Connelly
Brian D. Correia
*Mary E. Curran
Susan M. D'Acchioli
Georgia L. Deacutis
*Michael R. De Felice
Teresa M. Del Prete
magna cum laude
Thomas J. DePetro, Jr.
Maria E. DiGiuseppe
Anna B. Farrell
Ann M. Fegatelli
Lu-Ann Ferrucci
Nancy A. Fidrych
John Fobert
Donna M. Fournier
cum laude
General Education Honors
Rosemary Gately
Matthew J. Gendron
Karen E. Gentile
Jeffrey A. Gorman
Michael J. Hiltner
Donna A. Holmes
*John F. Jenkins
Matthew D. Kelley
Mark L. Kolodziej

Kathleen A. Lamb
Yanina Leytman
cum laude
Honors in Management
*Karen A. Lunnah
Mary M. Luther
Clifford R. Macomber
*Katherine R. Marses
*Karen A. McGee
Kevin McHugh
*Kathleen McMahon
Robert J. Moretti
*Michael G. Motta
*Carol J. Muller
*Ana A. Munoz
Christine M. Murphy

*Francis J. Murray
Timothy P. Murray
Laurie J. Pagliarini
*Ronald G. Parent
*Ramiro Pimento
Joseph A. Pitocco
Lee P. Podedworny
David R. Rancourt
cum laude
Paul J. Richard
†Kevin C. Ritchotte
Maria A. Rodrigues
Elizabeth A. Rose
Richard W. Rose
*Stephen P. Rowan
Norman A. Roy
Holly A. Rudinsky
*Christopher D. Santilli
Craig Schuele
Willard I. Seamans
*Mary E. Singleton
Benvinda T. Soares
Dennis P. Sullivan
Joe T. Szymkowicz
Paula J. Truesdell
Veronica M. Walsh
Natalie L. Wilkinson
Pamela J. Williams
Kenneth J. Wilson
Kathy A. Wood
Susan L. Wright

MARKETING

Karen A. Apuzzo
*Roger G. Bacon
*Russell Blackledge
*Albert J. Bucci
*Lynn S. Dean
John A. DeSimone, Jr.
*Gina M. DiChiario
Domenic F. Fusco

*AUGUST 1986 GRADUATE

†JANUARY 1986 GRADUATE

SCHOOL OF SOCIAL WORK

Bachelor of Social Work

Marcie B. Akell	Michelle R. Finnegan	*Patricia Martinez	Gail S. Ruggles
Paul J. Araujo	Karen G. Fogarty	Lillian B. Mayer	<i>magna cum laude</i>
<i>cum laude</i>	Jane E. Godlewski	Sheila A. McDonald	<i>Bachelor of Social Work</i>
*Doreen V. Behm	Elaine K. Grenon	Constance I. Mullen	<i>Program Award -</i>
*William R. Benson	<i>cum laude</i>	Geline A. O'Connor	<i>Academic Excellence</i>
Ann-Louise J. Bova	Dana Ann Holden	*Jeanne M. O'Connor	*Karen J. Schmidt
Lisa A. Choquette	Claire I. Iannelli	Lori A. Petrush	<i>magna cum laude</i>
Dorn M. Cunningham	Ann E. Incollingo	*Teofila C. Rosario	Thomas E. Stafford
JoAnn DiMuccio	<i>magna cum laude</i>	Janet Rossi	<i>Bachelor of Social Work</i>
Diane Marie Erskine-Kisseberth	Gail T. Jalette	<i>magna cum laude</i>	<i>Program Award -</i>
*Wendy A. Feijo	Mary J. Kingsland		<i>Service Excellence</i>
	Jacklynn M. Lantry		Colleen J. Viana
	Elizabeth C. Lowry		<i>cum laude</i>

SCHOOL OF EDUCATION AND HUMAN DEVELOPMENT

Bachelor of Arts

**ELEMENTARY EDUCATION
EARLY CHILDHOOD**

Kathleen E. Bessette
Victoria A. Brearton
Gayle M. Cipriano
Valerie A. Colasanto
Shirley A. Fairbanks
cum laude
Brenda L. Goddard
cum laude
Julia Leonard
Lynn J. Napolitano
Gold Key Society
Nellie E. Parker
Cynthia A. Siler
magna cum laude
Eileen E. Wayland

**ELEMENTARY EDUCATION
GENERALIZED**

Joanne M. DelAngelo
Patricia A. Dorchies
Marla A. Mendillo
Celia Munir
Lloydanne E. Oliver

SECONDARY EDUCATION

Peter C. Contre
*Helene Cosme
Alison D. Creswick
*Moir A. Greenson
Ginny A. Lemieux
Susan M. Lewis
*Mary H. Markey
Melanie A. Matrumalo
cum laude
Dennis O. Morrell
cum laude
*Nelson A. Guertin Memorial
Award - French
Tegu Polyglot Award*
Lynn M. Oliver
magna cum laude
*General Education Honors
Honors in History
Claiborne deB. Pell Award*
Linda J. Pompeii

Christopher A. Pride
cum laude

Antonia M. Santos
Joseph M. Theroux
Stephen M. Toohy
Claire R. Woodman
William P. Yorston

Bachelor of Science

ART EDUCATION

Linda A. Klingel
Charles E. Shea

**ELEMENTARY EDUCATION
EARLY CHILDHOOD**

Sharon L. Arena
Kathleen T. Cloutier
Sandra A. Connors
Ann E. Fogarty
*Ann Marie Glynn

Lisa K. Kappas
magna cum laude
*Elementary Education
Faculty Award*

Jane E. Mapes
Elaine M. Mastracchio
Robin L. McGreevy
cum laude
Elizabeth M. Palmer
Sheryl L. Ponder
Steven Stours
*Melissa J. Thornton

**ELEMENTARY EDUCATION
GENERALIZED**

Dorothy E. Allen
Carol A. Beaulieu
Jane P. Borden
Lisa D. Botelho
cum laude
Mary-Jane Bressette
cum laude
Amanda J. Brown
summa cum laude
*General Education Honors
Elementary Education
Faculty Award*

Maria A. Bruno
Anne E. Carey
*Denise M. Carpenter
Susan P. Cicilline
*Ann-Marie R. Curry
Georgette R. Dupuis
cum laude
Lizabeth J. Hughes
*Joyce Iantosco
Rebecca J. LePage
Margaret M. Logan
Christine A. McCarthy
cum laude
Janet M. McCarthy
Claudette H. Recore
magna cum laude
Josephine A. Stillings Award
Carmen Rico
*Janice S. Sardelli
Charlene A. Williams
summa cum laude

HEALTH EDUCATION

Michelle DeSerres
Susan A. DiSia
Gold Key Society
David A. King
Sharon A. O'Gara
*Carolyn E. Oliver
Lisa A. Rizzo

INDUSTRIAL ARTS

*Richard M. Baylor
Michael A. Berndt
*Epsilon Pi Tau, Beta Sigma
Chapter Award*
Ya-Sin Dhulkif
*Epsilon Pi Tau, Beta Sigma
Chapter Award*
Sean P. Durigan
Thomas W. Hunt, Sr.
Irene H. Larivee
cum laude
Cheryl J. Marshall
Anthony Osowski
Allen D. Waite

INDUSTRIAL TECHNOLOGY

Scott M. Atkinson
Ronald V. Bantug
Larry E. Beckenstein
Thomas G. Blais
Timothy M. Crowley
Anthony G. DeRosa
Michael Francisco
Michael Giacheri
*Gregory D. Haberek
*Arthur R. Hamilton, Jr.
Michael Hauser
cum laude
Richard J. Holden III
*Craig S. Homan
*Donald A. Lauzon
James M. Lizotte
John S. Marr
Steven J. McCormick
Eugene L. Oakland
*Ajani O. Okunola
Taiwo O. Oworu
Ahmet Ozdemir
Monique L. Rouleau
*Scott J. Salisbury
Samuel Walker VII
Gary R. Whaley

MUSIC EDUCATION

Frances Mencucci
cum laude
Cantor Jacob Hobenemser Award

PHYSICAL EDUCATION

*Gina M. Campellone
*Lisa Anne Dubé
David T. Kayata
Doreen M. Pike
*Jeffrey A. Silveira

**VOCATIONAL-INDUSTRIAL
EDUCATION**

George R. Brew
Marie C. Pastine
Robert A. Plouff
William J. Valerio

COMMENCEMENT COORDINATOR

Kathryn M. Sasso

COMMENCEMENT MARSHALS

Grand Marshal

Robert E. Viens

Platform Marshal

Dolores A. Passarelli

Brian R. Allen

William M. Baird

Deborah Barshay

Rachel H. Carpenter

Lynda J. Christiansen

Douglas G. Cureton

Gail H. Davis

Allan L. Fingeret

James E. Gilcreast, Jr.

Diana L. Gregoire

Linda P. Hunt

Phyllis Hunt

William F. Kavanaugh

Bennett J. Lombardo

Cheryl Maggiacomo

Lisa R. Maine

Linda M. McEnery

Rene H. Perreault, Jr.

Holly L. Shadoian

Antonio L. Veloso

Janice M. Ward

Sally M. Wilson

Cherie S. Withrow

STUDENT MARSHALS AND USHERS

The Gold Key Society

COLOR GUARD

Rhode Island College ROTC

BEARERS OF THE DEL SESTO MACE

Processional

George M. Epple

Chair, Council of Rhode Island College

Recessional

Noreen M. Andreoli

President, Rhode Island College Alumni Association

MUSICAL SELECTIONS

Rhode Island College Wind Ensemble

Francis M. Marciniak, *Director*

GOVERNOR OF THE STATE OF RHODE ISLAND AND PROVIDENCE PLANTATIONS
His Excellency Edward D. DiPrete

BOARD OF GOVERNORS FOR HIGHER EDUCATION

Robert V. Bianchini	Louise T. Kazanjian
Stephen M. Burns	Paul A. MacDonald
Augustine Capotosto, Jr.	Blanche R. Murray
Albert E. Carlotti, Chairman	Henry J. Nardone
Miriam Curtis Coleman	William C. O'Neill
George Graboys	

COMMISSIONER OF HIGHER EDUCATION

Eleanor M. McMahon

OFFICERS OF RHODE ISLAND COLLEGE

Carol J. Guardo
President

Willard F. Enteman
Provost and Vice President for Academic Affairs

John Nazarian
Vice President for Administration and Finance

Gary M. Penfield
Vice President for Student Affairs

John S. Foley
Vice President for College Advancement and Support

John J. Salesses
Assistant Vice President for Academic Affairs and Dean, School of Graduate Studies

David L. Greene
Dean, Faculty of Arts and Sciences

James D. Turley
Dean, School of Education and Human Development

George D. Metrey
Dean, School of Social Work

John H. Nissen
Dean of Admissions

PRESIDENTS EMERITI

William C. Gaige Joseph F. Kauffman

FACULTY OF ARTS AND SCIENCES

Area 2

Reception to be held
on the Art Center Patio

*(In case of rain,
Bannister Gallery)*

M.A.T.

Art Education
Music

B.A.

Liberal Arts in:

Art History

Art Studio

Communications

Music

Theatre

B.F.A.

Studio Art

B. of M.

Music Performance

B.S.

Art Education

Music Education

Area 3

Reception to be held
on the Fogarty West Lawn

*(In case of rain,
Nursing Lounge,
first floor of Fogarty Building)*

M.A.

Biology

M.A.T.

Biology

Physical Science

B.A.

Biology

Chemistry

Physical Science

B.S.

Chemistry

Medical Technology

Nursing

Radiologic Technology

Area 4

Reception to be held
on the Adams Library Lawn

*(In case of rain,
first floor, Adams Library)*

M.A.

Developmental Psychology

English

French

History

Individualized Program

Mathematics

Personality and

Social Psychology

M.A.T.

English

French

History

Individualized Program

Spanish

B.A.

Liberal Arts

(except those in Areas 2 & 3)

Secondary Education

(with Liberal Arts majors)

B.G.S.

B.S.

Accounting

Computer Information Systems

Liberal Arts

(except Chemistry)

Management

Marketing

SCHOOL OF SOCIAL WORK

Area 5

Reception to be held
on the grounds,
School of Social
Work Building

*(In case of rain,
the reception will move
indoors, same location)*

M.S.W.

B.S.W.

Immediately following the Commencement ceremonies receptions will be held for all graduates and their families.
The receptions, hosted by the Deans of each school, are located as follows:

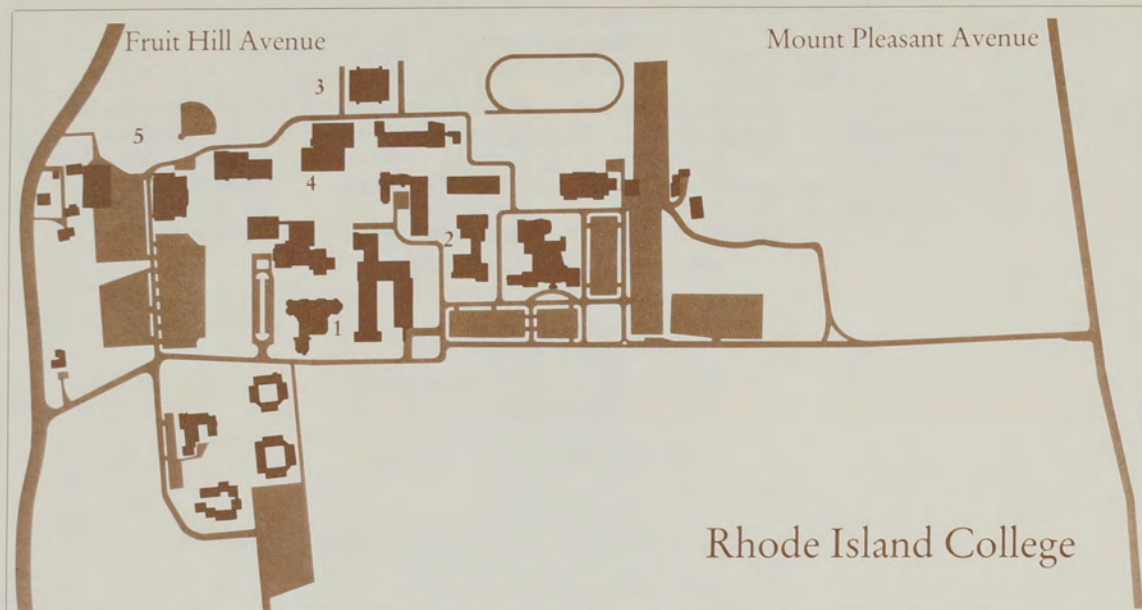

SCHOOL OF EDUCATION AND HUMAN DEVELOPMENT

Area 1

Reception to be held on the lawn between Henry Barnard School gymnasium and Horace Mann Hall

*(In case of rain,
Henry Barnard School Cafeteria)*

Graduate Degrees

C.A.G.S.
Counselor Education
Curriculum
Educational Administration
Individualized Program
Instructional Technology
Reading
School Psychology
Special Education

M.A.

Agency Counseling
Rehabilitation Counseling
Educational Psychology

M.A.T.

Elementary Education

M.Ed.

Bilingual-Bicultural Education
Counselor Education
Educational Administration-Elementary
Educational Administration-Secondary
Elementary Education
Elementary Education-Early Childhood
English as a Second Language
Health Education
Industrial Education
Individualized Program
Reading
Secondary Education
Special Education
(all M.Ed. programs)

M.S.

Instructional Technology

Undergraduate Degrees

B.A.

Elementary Education-Early Childhood
Elementary Education-Generalized
Elementary Education-Specialized

B.S.

Elementary Education-Early Childhood
Elementary Education-Generalized
Health Education
Industrial Arts
Instructional Technology
Physical Education
Vocational-Industrial Education

ALMA MATER

4 measures of introduction

GRACE E. BIRD

GRACE E. BIRD
HELEN S. LEAVITT

MODERATO

Dear Al - ma Ma - ter wise and kind, To thy fair name shall
e'er be - long our grate - ful prais - es and our love, The trib - ute of our
song, — Thou guard - ian of the sa - cred shrine of truth that makes us
free. We cher - ish thy be - lov - ed fame and pledge our loy - al -
ty. Rhode Is - land Col - lege hail to thee! All hail to Al - ma
Ma - ter! En - shrined thou art with - in the heart of ev - 'ry son and daugh - ter.

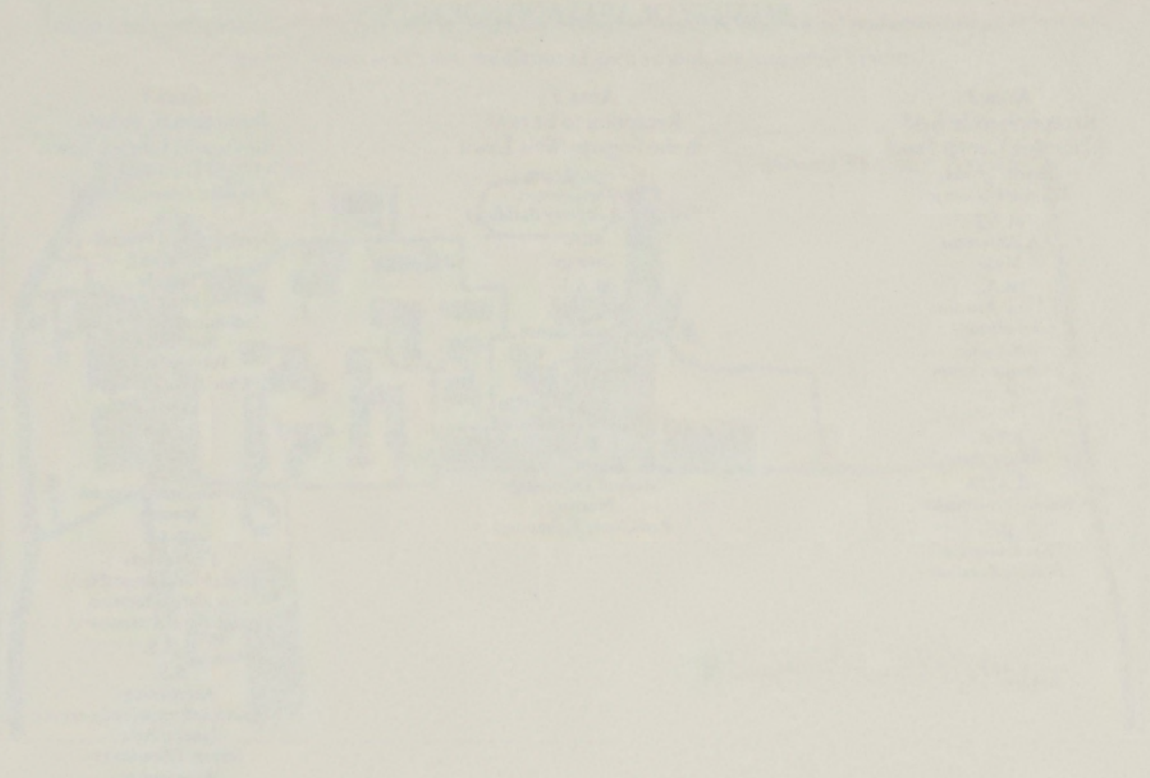

STUDY OF THE HISTORY OF THE
CITY OF PHOENIX

BY
JAMES H. HARRIS

The history of the city of Phoenix, Arizona, is a story of growth and development. It begins with the early pioneers who first settled in the area, and continues through the years of struggle and triumph. The city has grown from a small town to a major metropolitan area, and its history is a testament to the resilience and spirit of its people. The early years were marked by hardship and adversity, but the city always managed to overcome its challenges and emerge stronger than before. Today, Phoenix is a thriving city, and its history is a source of pride and inspiration for all who call it home.

